



OPERATION, SERVICE AND PARTS OF FRONT MOUNTING KIT

SAFETY PRECAUTIONS

If any operating, service or parts problems are encountered, please call G&B Specialties, Inc. for technical assistance.



- Failure to heed to any of the following warnings could result in severe bodily injury and/or equipment damage.
- Read and understand this manual completely before attempting operation of the railgear equipped vehicle.
- Operating instructions provided below only address the Rafna Industries railgear equipment. Applicable railway company procedures and policies must be adhered to.
- Railway company rules governing rail travel must be observed at all times.
- Before performing any work under the vehicle or railgear, ensure the engine is turned off and the parking brake is set.
- Never operate the vehicle if the Gross Vehicle Weight Rating (GVWR), Gross Axle Weight Rating Front or Rear (GAWR), or the wheel or tire load ratings are exceeded.



OPERATION OF FRONT MOUNTING KIT

With the front mounting kit installed on this vehicle, it may be operated as normal, however the mounting plates are located further forward than the front bumper. Caution must be used when operating the vehicle.

Never operate the vehicle if the Gross Vehicle Weight Rating (GVWR), Gross Axle Weight Rating Front or Rear (GAWR), or the wheel or tire load ratings are exceeded.

SERVICE OF FRONT MOUNTING KIT

The front mounting kit must be serviced regularly to avoid damage to the equipment. Table 1 below provides the Recommended Service Schedule and Table 2 provides Standard Fastener Torque Values.

Table 1: Recommended Service Schedule

Service Required	Initial 100 km (62 Miles) of road and/or rail use	Daily	Weekly	Monthly
Inspect front mounting kit fasteners (re-torque if required)		✓	✓	✓

Table 2: Standard Fastener Torque Values

Fastener Size	Fastener Torque Value (ft-lbs) Dry
1" UNC Gr. 8 Fasteners	250
¾" UNC Gr. 8 Fasteners	175
⅝" UNC Gr. 8 Fasteners	150
½" UNC Gr. 8 Fasteners	100
⅜" UNC Gr. 8 Fasteners	40
¼" UNC Gr. 8 Fasteners	12



PARTS OF FRONT MOUNTING KIT

NOTE:
1- IDENTICAL FASTENERS NOT SHOWN
FOR CLARITY

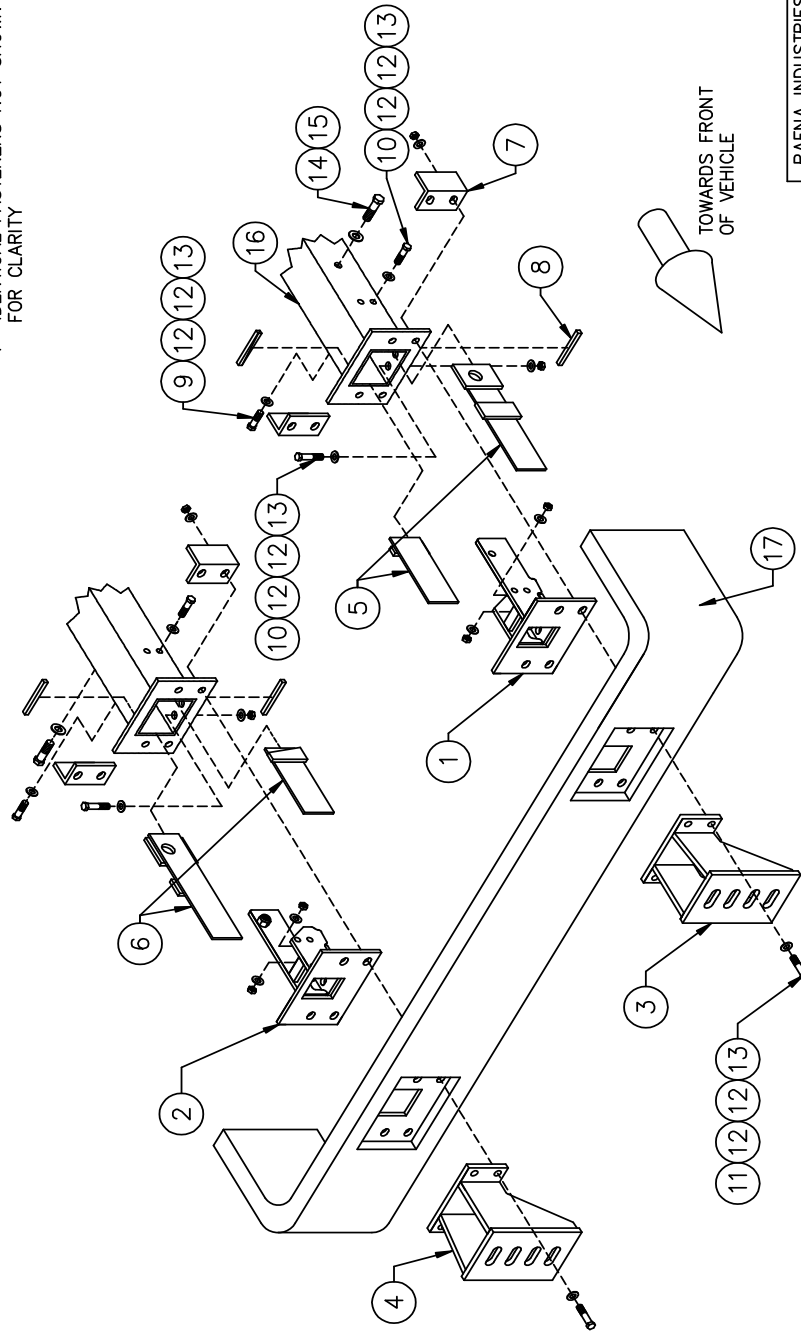

RAFNA INDUSTRIES LTD. 10300 CLARK - GRAHAM BLVD DUPEL, QUEBEC (514) 457-4373
DESCRIPTION: FRONT MOUNTING KIT
REFERENCE:
MATL:
P/N: K-M45RXFF001 DATE: MARCH 12/04
DRAWN: MER APPR:
DIM: INCHES SCALE: 1:1
SHEET: 1 OF 1 DWG#: K-M45RXFF001

ITEM	PART NO.	DESCRIPTION	QTY	ITEM	PART NO.	DESCRIPTION	QTY
1	R-4675D	FRONT REINFORCEMENT - LEFT SIDE	1	10	--	1/2" UNC GR.8 BOLT X 2.25" LONG	8
2	R-4675P	FRONT REINFORCEMENT - RIGHT SIDE	1	11	--	1/2" UNC GR.8 BOLT X 3" LONG	8
3	R-4860D	FRONT MOUNTING PLATE - LEFT SIDE	1	12	--	1/2" GR.8 WASHER	44
4	R-4860P	FRONT MOUNTING PLATE - RIGHT SIDE	1	13	--	1/2" UNC GR.8 NYLON INSERT LOCK NUT	22
5	R-4894D	SHIM KIT - LEFT SIDE	1	14	--	5/8" UNC GR.8 BOLT X 2.25" LONG	2
6	R-4894P	SHIM KIT - RIGHT SIDE	1	15	--	5/8" GR.8 WASHER	2
7	R-4893A	REINFORCEMENT ANGLE	4	16	--	VEHICLE FRAME	N/A
8	58-038/038	3/8" SQUARE BAR X 4" LONG	4	17	--	OEM FRONT BUMPER	N/A
9	--	1/2" UNC GR.8 BOLT X 2" LONG	6				