



OPERATION, SERVICE AND PARTS OF COVER PLATE OPTION KIT

SAFETY PRECAUTIONS

If any operating, service or parts problems are encountered, please call G&B Specialties, Inc. for technical assistance.



- Failure to heed to any of the following warnings could result in severe bodily injury and/or equipment damage.
- Read and understand this manual completely before attempting operation of the railgear equipped vehicle.
- Operating instructions provided below only address the Rafna Industries railgear equipment. Applicable railway company procedures and policies must be adhered to.
- Railway company rules governing rail travel must be observed at all times.
- Before performing any work under the vehicle or railgear, ensure the engine is turned off and the parking brake is set.
- Never operate the vehicle if the Gross Vehicle Weight Rating (GVWR), Gross Axle Weight Rating Front or Rear (GAWR), or the wheel or tire load ratings are exceeded.



OPERATION OF COVER PLATE OPTION KIT

With the cover plate option kit installed on this vehicle, it may be operated as normal. Side wands are located on the front bumper to aid in determining the length and width of the vehicle. Caution must be used when operating the vehicle.

Never operate the vehicle if the Gross Vehicle Weight Rating (GVWR), Gross Axle Weight Rating Front or Rear (GAWR), or the wheel or tire load ratings are exceeded.

SERVICE OF COVER PLATE OPTION KIT

The cover plate option kit must be serviced regularly to avoid damage to the equipment. Table 1 below provides the Recommended Service Schedule and Table 2 provides Standard Fastener Torque Values.

Table 1: Recommended Service Schedule

Service Required	Initial 100 km (62 Miles) of road and/or rail use	Daily	Weekly	Monthly
Inspect cover plate option kit fasteners (re-torque if required)		✓	✓	✓

Table 2: Standard Fastener Torque Values

Fastener Size	Fastener Torque Value (ft-lbs) Dry
1" UNC Gr. 8 Fasteners	250
3/4" UNC Gr. 8 Fasteners	175
5/8" UNC Gr. 8 Fasteners	150
1/2" UNC Gr. 8 Fasteners	100
3/8" UNC Gr. 8 Fasteners	40
1/4" UNC Gr. 8 Fasteners	12



PARTS OF FRONT MOUNTING KIT

REV	CHANGE	DATE	BY	APPD.
A	UNITS/ISS RELEASED	7/16/08	JWP	

IDENTICAL FASTENERS NOT SHOWN FOR CLARITY

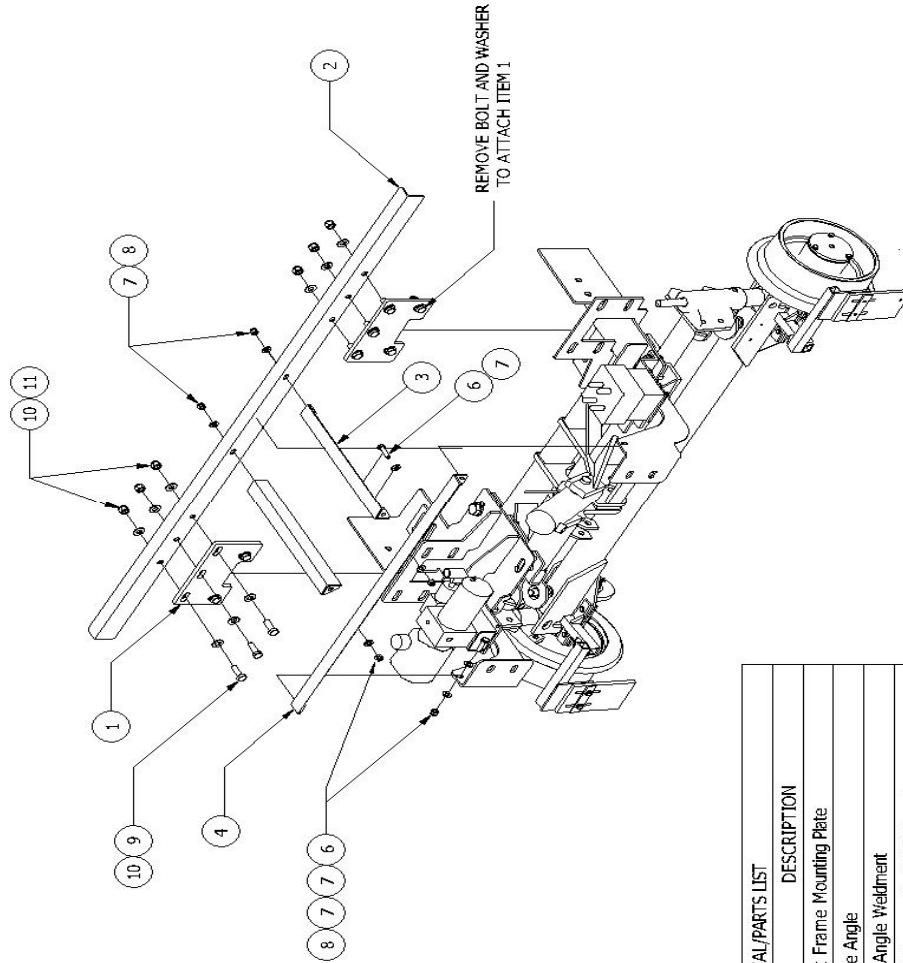

BILL OF MATERIAL/PARTS LIST	
ITEM	DESCRIPTION
1	2 R-19020 Front Frame Mounting Plate
2	1 R-19021 Frame Angle
3	2 R-19027 Side Angle Weldment
4	1 R-19025 Front Bumper Angle Weldment
5	1 R-19015 Cover Plate (Not Shown for Clarity)
6	6 H.H.C.S 3/8" UNC Gr. 8 Bolt X 1.50" Lg.
7	12 F*WASHER 3/8" Gr. 8 Washer
8	6 NYLOCKNUT 3/8" UNC Gr. 8 Nylon Insert Lock Nut
9	6 H.H.C.S 1/2" UNC Gr. 8 Bolt X 1.50" Lg.
10	12 F*WASHER 1/2" Gr. 8 Washer
11	6 NYLOCKNUT 1/2" UNC Gr. 8 Nylon Insert Lock Nut

G & B SPECIALTIES INC. <small>MANUFACTURER OF QUALITY RAILROAD PRODUCTS</small> <small>1000 W. MAIN ST. BERWICK, PA 17604-1000 TEL: 717-591-2000 FAX: 717-591-2005</small>	
DESIGN ~ ENGINEERING ~ MANUFACTURING <small>FOR CONSTRUCTION OF RAILROAD EQUIPMENT</small> <small>WE ARE COMMITTED TO EXCELLENCE IN THE SERVICE OF OUR CUSTOMERS</small> <small>FOR PARTS, CONTACT US AT: 717-591-2000</small>	
<small>TOLERANCE UNLESS OTHERWISE SPECIFIED</small> <small>UNLESS OTHERWISE SPECIFIED</small>	<small>RETURNS</small> <small>3 PLACE</small>
<small>BASIC DIMENSIONS</small> <small>UP TO 6 INCHES</small> <small>6 TO 30 INCHES</small> <small>30 INCHES TO 74 INCHES</small>	<small>2 PLACE</small> <small>1.064</small> <small>1.032</small> <small>1.016</small>
<small>3 PLACE</small> <small>.005</small> <small>.010</small> <small>.015</small>	<small>3 PLACE</small> <small>.005</small> <small>.010</small> <small>.015</small>
<small>ANGULAR DIMENSIONS</small> <small>: 10'</small>	<small>REVISION</small> <small>7/16/08</small> <small>1 of 1</small> <small>K-029RXFCVRPLTVAN2</small> <small>A</small>